

1949-1954 Chevy Power Brake Pedal Kit Install Sheet

1-866-925-1101

www.totalcostinvolved.com

**CHECK ALL PARTS INCLUDED IN THIS KIT TO THE PARTS LIST BEFORE INSTALLATING OF THE KIT.
IF ANY PIECES ARE MISSING, PLEASE CONTACT: TOTAL COST INVOLVED 800-925-1101**

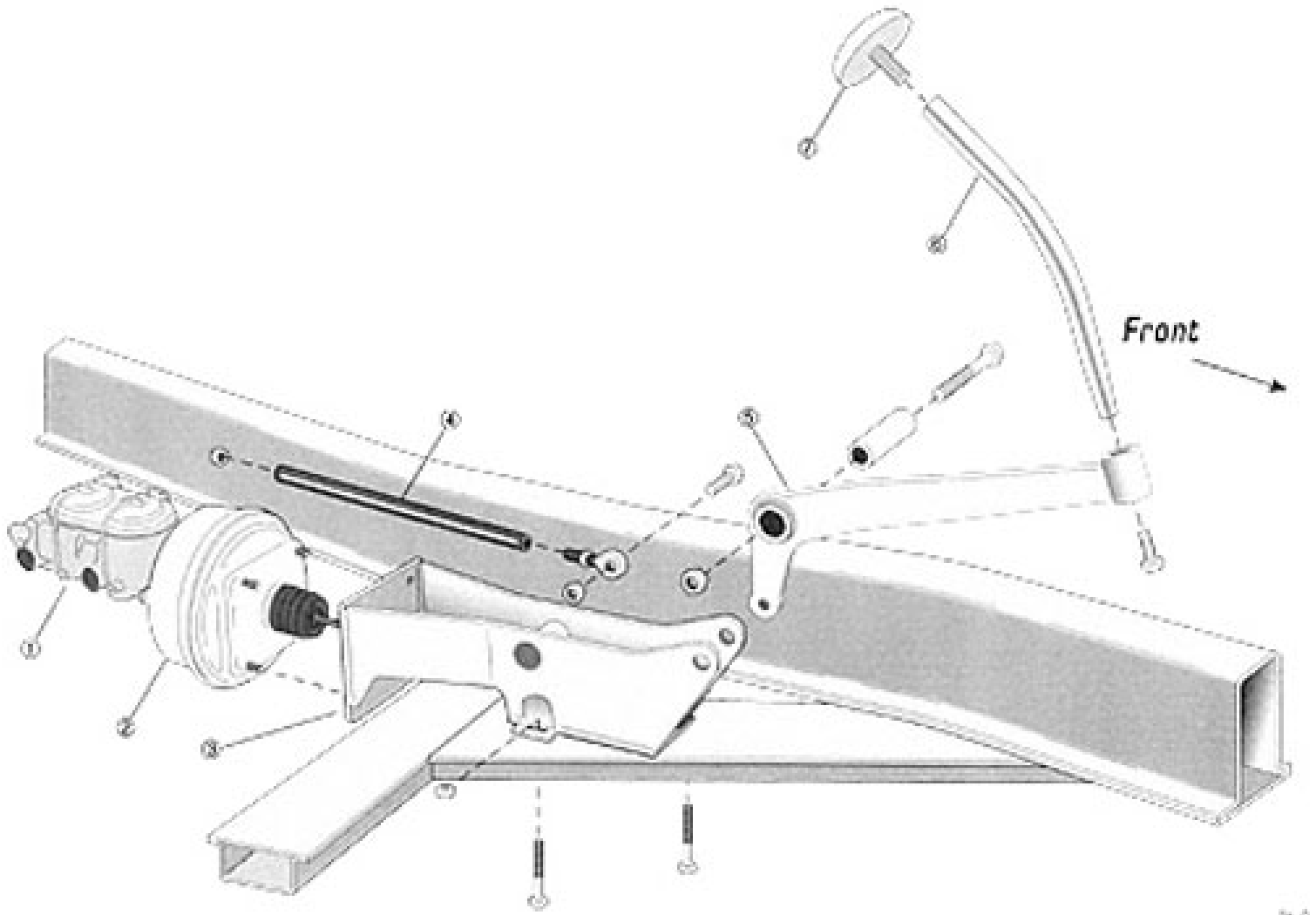

1. Remove original master cylinder, bracket and brake pedal
2. Clean the cross member where the brake bracket bolts to it
3. Assemble the master cylinder and power booster into the power brake bracket
4. Install bracket onto the cross member where the original bracket used to be, use the supplied bolts with the nuts on the top side
5. Install the lower section of the brake pedal to the bracket with the supplied sleeve and bolt

6. Install the push rod to the power booster and pedal heim
7. Install the upper section of the pedal into the lower pedal section, with the tapered section on the bottom
8. Adjust and rotate the upper pedal tube so it will go through the original hole in the floorboard and tighten the 3/8" bolt on the lower side of the tube to secure the pedal tube. Use Loctite on threads
9. Adjust the push rods so there is:
 - 1/2" of free play at the pedal pad (do not preload master cylinder).
 - Very little clearance between the firewall and lower pedal arm when the brake pedal is released
10. Check for interference and binding throughout the pedal travel
11. A new access hole on the floor needs to be cut out directly above the master cylinder
12. Install pedal pad, reroute brake lines, bleed brakes and run manifold vacuum to power booster
13. Test the brake system before driving the car