



CLASSIC PERFORMANCE PRODUCTS

[HOME](#)

[E-MAIL](#)

[TECH](#)

[BOOKS](#)

Classic Performance Products 175 East Freedom Avenue Anaheim, CA 92801

1935-'48 Independent Front Suspension

Anti-Sway Bar Installation

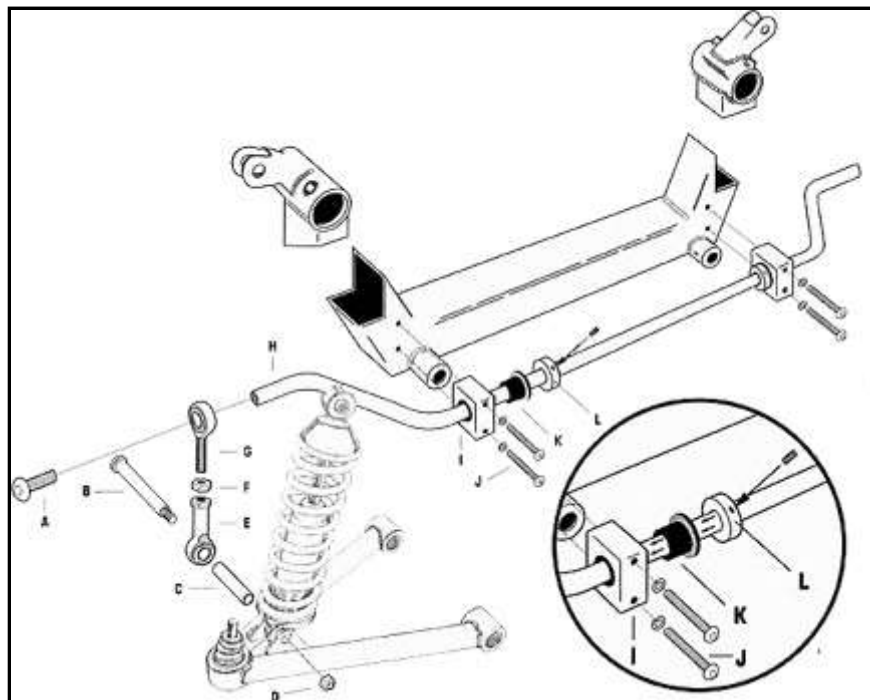

Parts List

No.	Description	Qty.
A.	Anti-Sway Bar Link Bolt	2
B.	Lower Coil-Over Shock Bolt	2
C.	Anti-Sway Bar Link Spacer	2
D.	Lower Coil-Over Shock Locknut	2
E.	Female Heim Joint Link	2
F.	Heim Joint Locknut	2
G.	Male Heim Joint Link	2
H.	Anti-Sway Bar	1
I.	Anti-Sway Bar Mount	2
J.	Anti-Sway Bar Mount Bolts	4
K.	Ant-Sway Bar Bushing	2
L.	Anti-Sway Bar Lock Sleeve	2

© Classic Performance Products Inc.

This "website" and all contents are property of Classic Performance Products Inc. [Disclaimer](#)



[HOME](#) [ORDER](#) [TECH](#) [BOOKS](#) [STEERING](#) [BRAKES](#) [SUSPENSION](#) [POLICIES](#)